



BEYOND SECURITY

KABA®

Kentaur Turnstiles Kentaur Full-Height Gates

Expertise in perimeter protection

«We attach great importance to perimeter protection on our premises. An intelligent fence system and automatic full-height turnstiles at all entrances mean we can respond with flexibility to the changing access control requirements of our company. Using an admission system we can control which of our 1200 members of staff are authorized to enter the premises - and when exactly they can do so. It is also easy to control access with bikes or goods carts thanks to special turnstiles.»





Secure Kentaur Turnstiles

The robust Kentaur turnstiles and Full-Height Gates are especially suited for perimeter security of areas and buildings. Versatile versions allow for individual combinations of multiple units. The patented locking system prevents people from being locked up.

Versatility

The product series Kentaur offers a modular design. 3- and 4-winged units with straight or U-shaped bars can be combined with each other. The same applies for units with integrated bicycle access or swing door, escape route function¹ or resistance class WK2. The roofs fit with any of the single, multiple or space saving double units.

Minimal Energy Consumption

The quiet low-energy drive consumes only very little energy and due to the low forces minimizes the risk of injury for the users during rotation.

Safe Passage

The endpoint locking implemented in Kentaur turnstiles prevents people from being locked up or jammed. After release the rotation may be stopped until halfway and the turnstile can be rotated backwards. If the turnstile is rotated more than halfway, the unit can only be left in the direction of release.

¹ Individual approval required (competent building authority)

Throughput rate	= up to 20 per minute
Security level	= ●●●●○
Comfort	= ●●○○○



Kentaur full-height gates in matching design offer a fitting solution for handicapped access.

Advantages of Kentaur Turnstiles

The right combination of security, user comfort and personal safety.

- > No locking up of people thanks to endpoint locking
- > Versions with integrated bicycle access, full-height gates for goods entrance, escape route function or resistance class WK2
- > Space-saving double units
- > Modular combination of bars, roofs, guiding and side elements
- > Enduring quality for in- and outdoor installation
- > Turnstile column and bars made of stainless steel
- > Rotation speed adapts to pedestrians
- > Low-energy drive
- > Low energy consumption
- > Free choice of behaviour in case of power failure
- > May be employed in areas of severe environmental conditions
- > Integrated random generator with parameters being assigned freely
- > Optional secondary identification for additional security
- > Spacing between shearing edges eliminates risk of injury

The fitting solution for any entrance situation



Units with curved acrylic glass roof



Mobile application - turnstile on pallet with integrated door for construction site protection



Version with integrated bicycle door



For staff entrance: multiple units in fence around premises



Double unit with roof element as weather and anti-climbing guard

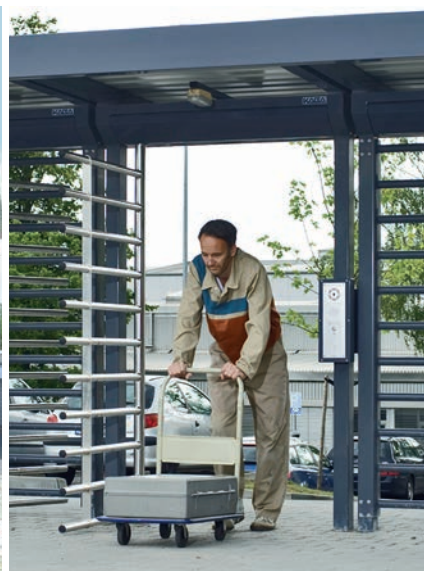

Integrated full-height gates as goods entrance

Basic equipment



	FTS-E01	FTS-E02	Option
Construction			
Column diameter	1130	1300	
Portal width	1370	1540	
Total height	2270	2270	
Total height with optional roof D1	2390	2390	
optional roof D2	2420	2420	
optional roof D3	2420	2420	
optional roof D4	-	2770	
Passage height	2060	2060	
Passage width	560	646	
Portal and housing	Steel.	Steel.	
Lockable maintenance openings	Aluminium.	Aluminium.	
Rotating unit with tubular column Ø 89 mm	180°, each with 11 straight crossbars Ø 40 mm made of stainless steel glossy AISI 304 with black plastic covering caps.	120°, each with 11 straight crossbars Ø 40 mm made of stainless steel glossy AISI 304 with black plastic covering caps.	
Barrier element	With 11 straight horizontal crossbars Ø 42 mm made of steel.	With 11 straight horizontal crossbars Ø 42 mm made of steel.	
Entry/exit enclosure	With vertical steel bars.	With vertical steel bars.	
Special feature	-	-	
Finish	Rotating unit in stainless steel glossy, steel elements hot-dip galvanized aluminium elements in RAL 9006 (white aluminium).	Rotating unit in stainless steel glossy, steel elements hot-dip galvanized aluminium elements in RAL 9006 (white aluminium).	
Function	Typ 2 ****	Typ 0 * Typ 1.1 ** Typ 1.2 *** Typ 2 ****	
Electrical components	Control system integrated in the unit. Power supply 110-230 VAC 50/60 Hz. Standby power consumption 20 VA.	Control system integrated in the unit. Power supply 110-230 VAC 50/60 Hz. Standby power consumption 20 VA.	
Installation	In sleeve foundation measurement X = 150 mm.	In sleeve foundation measurement X = 150 mm.	
Protection class	Housing IP33, components conducting supply voltage IP43.	Housing IP33, components conducting supply voltage IP43.	

* Type 0

Manual motion; mechanically free in one direction/opposite direction blocked

** Type 1.1

Manual motion; 1 direction electrically controlled/ opposite direction blocked (behavior in case of power failure: both directions blocked or one direction free, one direction blocked)

*** Type 1.2

Manual motion; 2 directions electrically controlled (behavior in case of power failure: both directions blocked or both directions free)

**** Type 2

Power assisted motion; servo-positioning drive/ 2 directions electrically controlled (behavior in case of power failure can be chosen for each direction: free or blocked)

All dimensions in mm

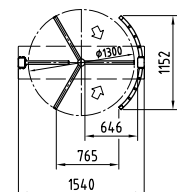
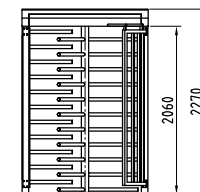
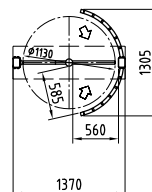
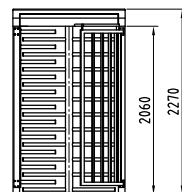



FTS-E06

1300
2340
2270
2390
2420
2420
-
2060
646
Steel.

Aluminium.

120°, each with 11 straight crossbars Ø 40 mm made of stainless steel glossy AISI 304 with black plastic covering caps.

In middle part with 21 straight crossbars Ø 42 mm made of steel.

With vertical steel bars.

Marginal space requirement due to intermeshing rotating units.

Rotating unit in stainless steel glossy, steel elements hot-dip galvanized, aluminium elements in RAL 9006 (white aluminium).

Typ 0 *
Typ 1.1 **
Typ 1.2 ***
Typ 2 ****

Control system integrated in the unit.

Power supply 110-230 VAC 50/60 Hz.

Standby power consumption 20 VA.

In sleeve foundation measurement X = 150 mm.

Housing IP33, components conducting supply voltage IP43.



FTS-E03

1300
1540
2270
2390
2420
2420
2770
2060
550
Steel.

Aluminium.

90°, each with 11 straight crossbars Ø 40 mm made of stainless steel glossy AISI 304 with black plastic covering caps.

With 11 straight horizontal crossbars Ø 42 mm made of steel.

With vertical steel bars.

-

Rotating unit in stainless steel glossy, steel elements hot-dip galvanized, aluminium elements in RAL 9006 (white aluminium).

Typ 0 *
Typ 1.1 **
Typ 1.2 ***
Typ 2 ****

Control system integrated in the unit.

Power supply 110-230 VAC 50/60 Hz

Standby power consumption 20 VA.

In sleeve foundation measurement X = 150 mm.

Housing IP33, components conducting supply voltage IP43.

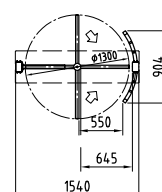
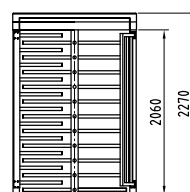
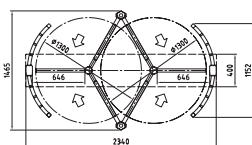
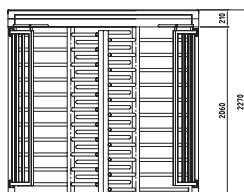

Basic equipment



Construction	FTS-E04	FTS-E05
Column diameter	1300	1300
Portal width	1540	1500
Total height	2270	2270
Total height with optional roof D1	-	-
optional roof D2	-	-
optional roof D3	-	-
optional roof D4	-	-
Passage height	2060	2060
Passage width	646	656
Portal and housing	Steel.	Steel.
Lockable maintenance openings	Stainless steel AISI 304.	Aluminium.
Rotating unit with tubular column Ø 89 mm	120°, each with 13 straight crossbars Ø 40 mm made of stainless steel glossy AISI 304 with protection against sawing through and black plastic covering caps.	120°, each with 11 straight crossbars Ø 40 mm made of steel hot-dip galvanized and black plastic covering caps.
Barrier element	Curved with 12 steel bars and protection against sawing through in the vertical bars.	With 11 straight horizontal crossbars Ø 42 mm made of steel.
Entry/exit enclosure	With vertical steel bars.	With vertical steel bars.
Special feature	The unit corresponds to resistancy class WK2 according to DIN V ENV 1627 (test report 214 29703 ift Rosenheim).	-
Finish	Rotating unit in stainless steel glossy steel elements hot-dip galvanized, maintenance openings stainless steel in RAL 9006 (white aluminium).	Rotating unit in steel, steel elements hot-dip galvanized.
Function	Type 2 ****	Type 1.2***
Electrical components	Control system integrated in the unit. Power supply 110-230 VAC 50/60 Hz. Standby power consumption 20 VA.	Control system integrated in the unit. Power supply 110-230 VAC 50/60 Hz. Standby power consumption 20 VA.
Installation	In sleeve foundation measurement X = 150 mm.	On finished floor level FFL.
Protection class	Housing IP33, components conducting supply voltage IP43.	Housing IP33, components conducting supply voltage IP43.

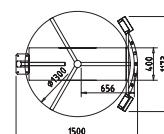
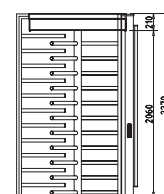
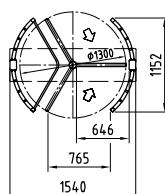
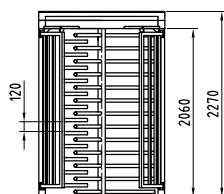

All dimensions in mm



FTS-M02

1300
2440
2270
2390
2420
2420
-

2060

646

Steel.

Aluminium.

120°, each with 7 curved crossbars Ø 27 mm made of stainless steel glossy AISI 304.

Curved with 7 horizontal steel bars.

Half-height, made of stainless steel tubes AISI 304 with plate panels. Automatic bike door with 3 curved crossbars Ø 27 mm and protection plate below. Tube frame, plate and crossbars made of stainless steel glossy AISI 304. Attached barrier element above the bike door with 2 curved crossbars Ø 27 mm and tube frame made of steel.

Rotating unit in stainless steel glossy, steel elements hot-dip galvanized, aluminium elements in RAL 9006 (white aluminium).

Type 2 ****

Automatic bike door with two induction loops and loop detector, two directions electrically controlled.

Control system integrated in the unit.

Power supply 110-230 VAC 50/60 Hz.

Standby power consumption 10 VA.

In sleeve foundation measurement X = 150 mm.

Housing IP33, components conducting supply voltage IP43.



FTS-M03

1130
1940
2270
2390
2420
2420
-

2060

560

Steel.

Aluminium.

180°, each with 11 straight crossbars Ø 40 mm made of stainless steel glossy AISI 304 with black plastic covering caps.

Integrated door with 10 straight horizontal steel crossbars Ø 42 mm and all-over frame with steel bars. Equipped with knob on both sides and catch bolt lock (prepared for customer's profile cylinder).

With vertical steel bars.

Integrated swing door for transit of goods.

Rotating unit in stainless steel glossy, steel elements hot-dip galvanized aluminium elements in RAL 9006 (white aluminium).

Type 0 *

Type 2 ****

Typ 2: The rotating unit turns automatically 90° in passage direction when the door is opened.

Control system integrated in the unit.

Power supply 110-230 VAC 50/60 Hz.

Standby power consumption 10 VA.

In sleeve foundation measurement X = 150 mm.

Housing IP33, components conducting supply voltage IP43.

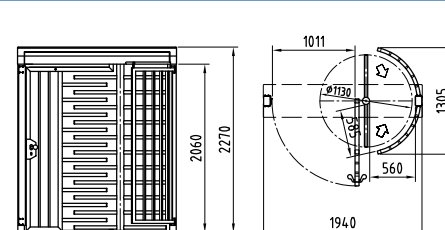
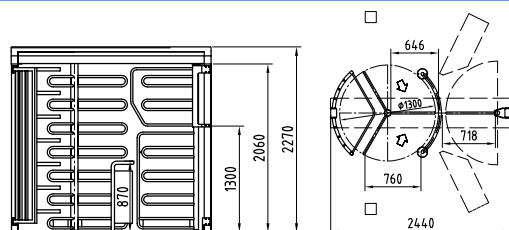

Basic equipment



		FTS-M05
Construction	Column diameter	1130
	Portal width	1940
	Total height	2270
	Total height with optional roof D1	2390
	optional roof D2	2420
	optional roof D3	2420
	optional roof D4	-
	Passage height	2060
	Passage width	560
	Portal and housing	Steel.
	Lockable maintenance openings	Aluminium.
	Rotating unit with tubular column Ø 89 mm	180°, each with 11 straight crossbars Ø 40 mm made of stainless steel glossy AISI 304 with black plastic covering caps.
	Barrier element	Integrated door with 10 straight horizontal steel crossbars Ø 42 mm and all-over frame with steel bars. Equipped with knob on both sides and panic lock (prepared for customer's profile cylinder), electric emergency door opener currentless open.
	Entry/exit enclosure	With vertical steel bars.
	Special feature	The unit has an emergency exit function.
		Rotating unit in stainless steel glossy, steel elements hot-dip galvanized, aluminium elements in RAL 9006 (white aluminium).
		Type 2 ****
		Emergency exit function: an „allowance in individual case“ from the highest authority on building supervision is necessary! The rotating unit turns automatically 90° in passage direction when the door is opened.
		Control system integrated in the unit.
		Power supply 110-230 VAC 50/60 Hz.
Electrical component:		Door terminal, including emergency button, key switch and emergency escape way symbol for emergency exit, installed inside at customers wall; meeting EltVTR requirements.
		Standby power consumption 20 VA.
		In sleeve foundation measurement X = 150 mm.
		Housing IP33, components conducting supply voltage IP43, door terminal IP44.
Installation		
	Protection class	

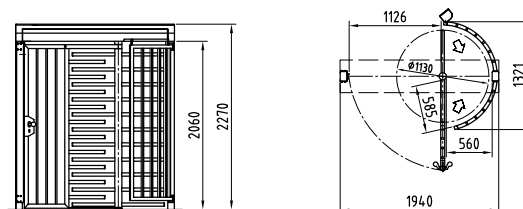

All dimensions in mm

Optional roofs

	FTS-E01	FTS-E02	FTS-E03	FTS-E04	FTS-E05	FTS-E06	FTS-M02	FTS-M03	FTS-M05
Roof D1 - depth 1500 or 2770 (total height 120)									
width									
1650	•								
1820		•	•						
2220								•	•
2620						•			
2720							•		
Roof D2 and Roof D3 - depth 2820, 3740 ((each with roof edge 200) or 4650 (roof edge 400)									
width									
1830	•								
2000		•	•						
2400								•	•
2800						•			
2900							•		
Roof D4 - depth 2000 (height 500)									
width									
1760		•	•						

Roofing for weather protection and climb-over protection

Roof D1

Steel sub-construction hot-dip galvanized, trapezoidal cover plate in RAL 9002 grey white (optional RAL powder coated).
For multiple units we deliver one oversized roof. For four units or more a central water drainage is required.
The distance between units is 50 mm.

Roof D2

Steel sub-construction hot-dip galvanized, trapezoidal cover plate in RAL 9002 grey white (optional RAL powder coated).
With roof edge silver anodized and water drainage in PVC grey.
From depth 3740 on, the unit has to be installed in sleeve foundation and be equipped with reinforced posts.
For multiple units we deliver one oversized roof. The distance between units is 50 mm.
The fascia is continuous. Its length is max. 6,4 m.

Roof D3

Steel sub-construction hot-dip galvanized, trapezoidal cover plate in RAL 9002 grey white (optional RAL powder coated).
With roof edge silver anodized and water drainage in PVC grey.
Roof underneath aluminium panelling in lotus white.
From depth 3740 on, the unit has to be installed in sleeve foundation and be equipped with reinforced posts.
For multiple units we deliver one oversized roof. The distance between units is 50 mm.
The fascia is continuous. Its length is max. 6,4 m.

Roof D4

Steel sub-construction hot-dip galvanized, curved acrylic glass cover, side mounted gutters in steel plate galvanized and water drainage in PVC grey.
Average snowload 75 kg/m² (higher snowloads on request).
For multiple units a roof is delivered whose number of curved roofs corresponds to the number of units.
The distance between units is 50 mm.

All dimensions in mm

Roof D1 - with trapezoidal cover plate

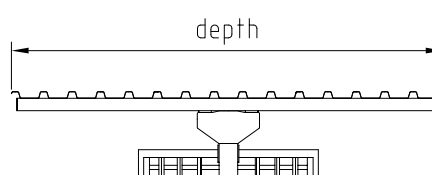
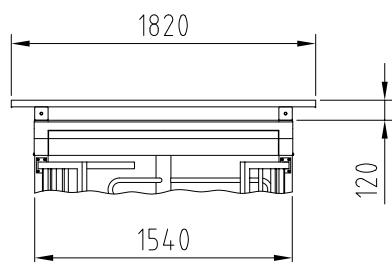

Roof D2 - with trapezoidal cover plate, roof edge profile and water drainage

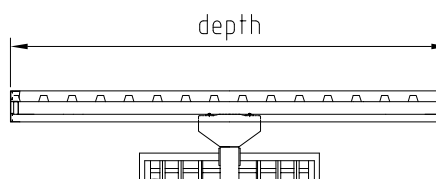
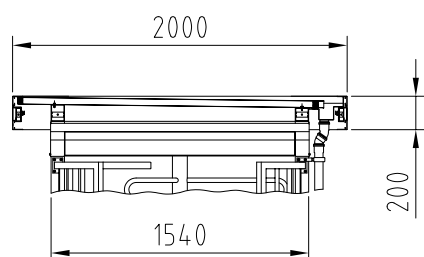

Roof D3 - with trapezoidal cover plate, roof edge profile, panelling and water drainage

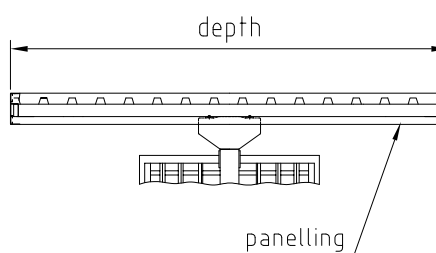
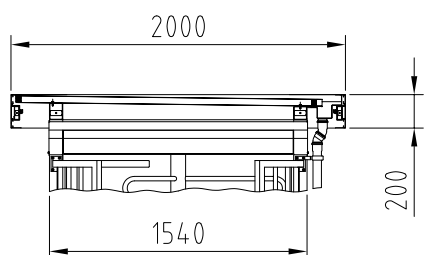

Roof D4 - with acrylic glass cover

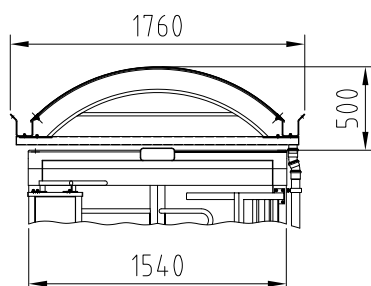

Options (depending on unit type and motor assembly)

	FTS-E01	FTS-E02	FTS-E03	FTS-E04	FTS-E05	FTS-E06	FTS-M02	FTS-M03	FTS-M05
Construction									
Housing with lockable front panel in light metal silver anodized, light metal powder coated according to RAL or stainless steel glossy.		•				•			
Roofs D1, D2, D3 and D4. Versions depending on unit type: hot-dip galvanized steel subconstruction and aluminium roof edge 200 or 400 as well as hot-dip galvanized trapezoidal plate, all powder coated according to RAL. The water drainage can be in stainless steel or powder coated in RAL instead of grey.	•	•	•			•	•	•	•
Curved barrier element hot-dip galvanized or powder coated according to RAL instead of straight crossbars.		•	•						
Rotating unit with curved crossbars inclusive curved barrier element.		•							
Rotating unit in stainless steel AISI 316 or stainless steel AISI 304.	•	•	•			•	•	•	•
For each direction: locking by turning lever with profile half cylinder, installed in maintenance opening.	•	•	•			•	•	•	•
Finish									
Steel and aluminium parts: additional powder coating according to RAL.	•	•	•	•	•	•	•	•	•
Function									
Door opener currentless open resp. currentless closed.								•	
Door opener with slide bar, installed in portal housing or drive type FDC for integrated door.								•	•
2 pieces of concrete with embedded induction loops instead of loose loops.							•		
Counter.								•	•
Random generator with or without horn.	•	•	•	•	•	•	•	•	•
Electrical components									
Power supply plug to supply external nodes, 24 VDC/1A.								•	•
Installation preparation on plane surface as rectangular cut-out for components provided by customer.	•	•	•			•		•	•
Installation plate with telescopic rails, in connection with „housing with lockable front panel“.		•				•			
Different consoles completely in stainless steel resp. plastic or aluminium in color of unit or in RAL 9006/ front panels of aluminium consoles available in plastic or stainless steel.	•	•	•	•		•		•	•
Release button for manual single release, integrated in plane surface, for protection against vandalism.	•	•	•	•	•	•			
Electric key switch for single or permanent release.								•	•
Operating panels and frame or housing for surface installation.	•	•	•	•	•	•	•	•	•
Additional boards to expand the existing in-/outputs for motor assembly type 2.	•	•	•	•	•	•	•	•	•
Various signal devices.	•	•	•		•	•	•	•	•
End wiring distributor to connect a maximum of four OPL05.								•	•
Various lightings and twilight switch.	•	•	•			•	•	•	•
Installation									
Turnstile can be assembled in the factory for „finished floor“ and „structural floor“ mounting.	•	•	•		•				
Mounting on finished floor X = 0.	•	•	•	•		•	•	•	•
Mounting on structural floor X = 150 mm.	•	•	•	•		•	•	•	•

All dimensions in mm

Housing with lockable front panel in aluminium silver anodized, with powder coating according to RAL or in stainless steel glossy.

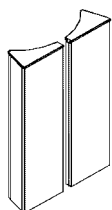

Console 1
in plastic in color of unit or RAL 9006.

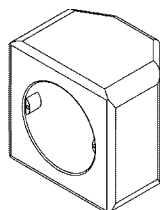

width 94 mm
height 94 mm
depth 65 mm

Console 2
in aluminium in color of unit or in RAL 9006
front panels in PVC grey or aluminium RAL 9006.

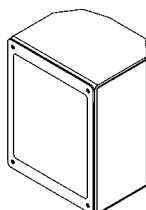

width 140 mm
height 180 mm
depth 110 mm

Console 3
in aluminium in color of unit or in RAL 9006
front panels in PVC grey or aluminium RAL 9006.

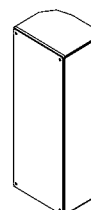

width 140 mm
height 365 mm
depth 110 mm

Installation alternatives, for instance FTS-E02

structural floor

finished floor

sleeve foundation

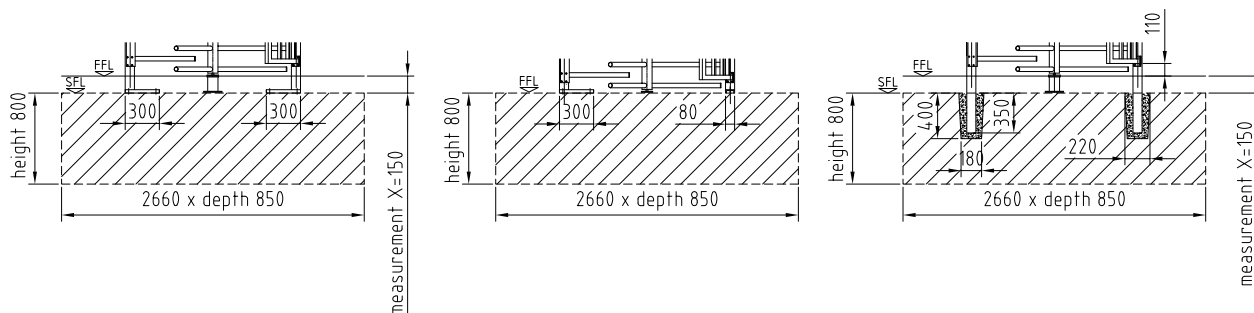

Full-Height Gate



Basic equipment

Application		FGE-M01
Construction		Passage of persons and material handling.
	Portal width	1370
	Total height	2270
	Total height with optional roof D1	2390
	optional roof D2	2420
	optional roof D3	2420
	Passage height	2060
	Passage width	1080
	Portal and housing	Steel.
	Lockable maintenance openings	Aluminium.
	Rotating wing with column Ø 89 mm	With 11 straight crossbars Ø 40 mm and vertical reinforcement plate made of stainless steel glossy AISI 304.
Finish		Swing door made of glossy stainless steel. Steel elements hot-dip galvanized. Aluminium elements in RAL 9006 (white aluminium).
Function		Type 2 *
Electrical components		Control system integrated in the unit. Power supply 110 - 230 VAC, 50/60 Hz.
Installation		In sleeve foundation measurement X = 150 mm.
Protection class		Housing IP33, components conducting supply voltage IP43.

* Type 2 power assisted motion; two servo-positioning drives/ electrically controlled in both directions

All dimensions in mm

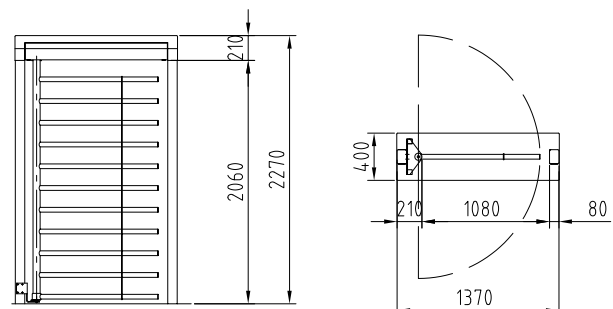

Optional roofs for FGE-M01

Roof D1

Depth 1500 or 2770 (total height 120)
Width 1650

Roof D2 and Roof D3

Depth 2820 (roof edge 200)
Width 1830

Roofing for weather protection and climb-over protection

Roof D1

Steel sub-construction hot-dip galvanized, trapezoidal cover plate in RAL 9002 grey white (optional RAL powder coated). For multiple units we deliver one oversized roof. For four units or more a central water drainage is required. The distance between units is 50 mm.

Roof D2

Steel sub-construction hot-dip galvanized, trapezoidal cover plate in RAL 9002 grey white (optional RAL powder coated). With roof edge silver anodized and water drainage in PVC grey. For multiple units we deliver one oversized roof. The distance between units is 50 mm. The fascia is continuous. Its length is max. 6,4 m.

Roof D3

Steel sub-construction hot-dip galvanized, trapezoidal cover plate in RAL 9002 grey white (optional RAL powder coated). With roof edge silver anodized and water drainage in PVC grey. Roof underneath aluminium panelling in lotus white. For multiple units we deliver one oversized roof. The distance between units is 50 mm. The fascia is continuous. Its length is max. 6,4 m.

Roof D1 - with trapezoidal cover plate

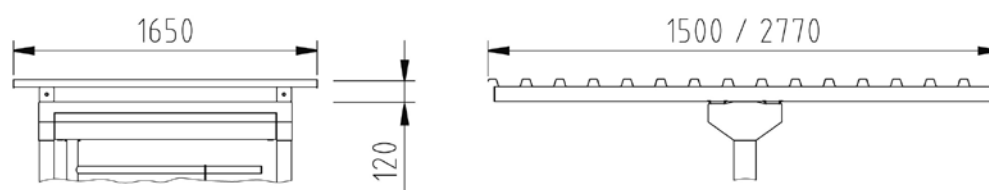

Roof D2 - with trapezoidal cover plate, roof edge profile and water drainage

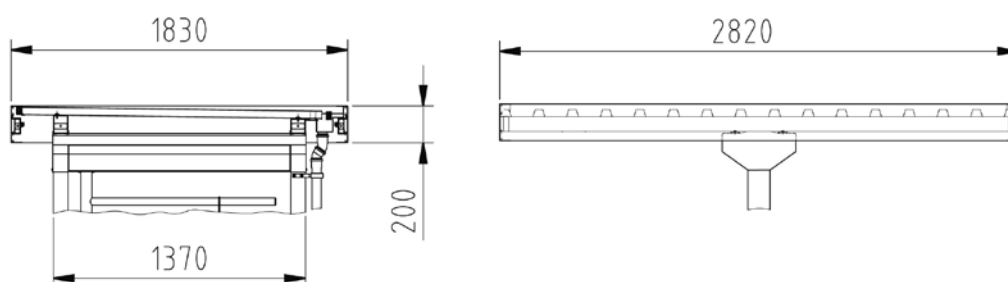

Roof D3 - with trapezoidal cover plate, roof edge profile, panelling and water drainage

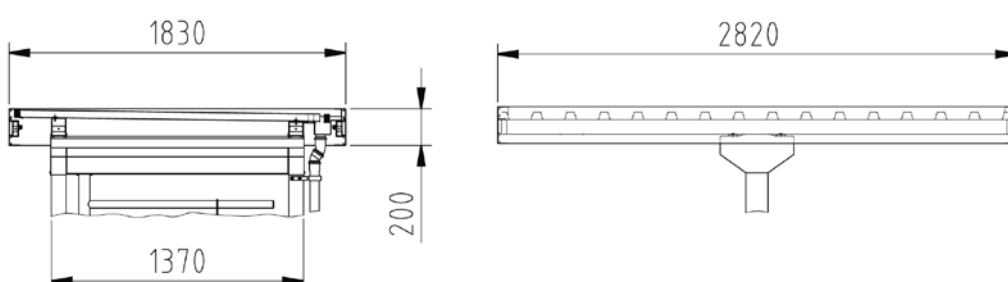

Options for FGE-M01

Construction

For each direction: unlocking by turning lever with profile half cylinder, installed in maintenance opening.

Finish

Steel and aluminium parts additionally finished with powder coating according to RAL.

Electrical components

Installation preparation on plane surface as rectangular cut-out for components provided by customer.

Different consoles completely in stainless steel resp. plastic or aluminium in color of unit or in RAL 9006/
front panels of aluminium consoles available in plastic or stainless steel.

Operating panels and frame or housing for surface installation.

Additional boards to expand the existing in-/outputs.

Various signal devices.

Heating.

Various lightings an twilight switch.

Installation

Mounting on finished floor X = 0.

Mounting on structural floor X = 150.

Installation alternatives, for instance FGE-M01

sleeve foundation

finished floor

structural floor

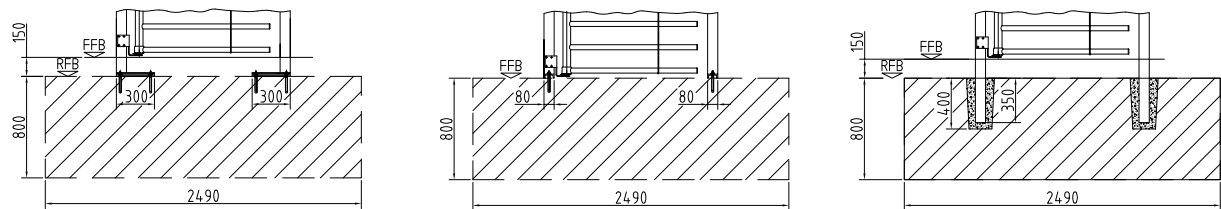

All dimensions in mm



BEYOND SECURITY